

A grayscale background image showing several pairs of hands in business attire, some holding pens, gathered around a table reviewing documents. The image is slightly blurred and has a dark overlay.

# Confronting COVID-19

## Making Moves: Transportation, Public Space, and Equity in the Time of Coronavirus

September 11, 2020



## URBAN LAND INSTITUTE

Provide leadership in the responsible use of land and in creating and sustaining thriving communities worldwide

## BUILDING HEALTHY PLACES

Leveraging the power of ULI's global networks to shape projects and places in ways that improve the health of people and communities

[health@uli.org](mailto:health@uli.org)



**Convenings | Research | Best Practices | Education**

This webinar is being recorded and will be archived on ULI's Knowledge Finder.  
A link and a post-session survey will be shared following the session.

Join Us

## ULI Building Healthy Places Virtual Forum

Wednesday, October 7 | 10:30 am to 4:00 pm

Part of ULI's Virtual Fall Meeting  
[fall.uli.org](https://fall.uli.org)

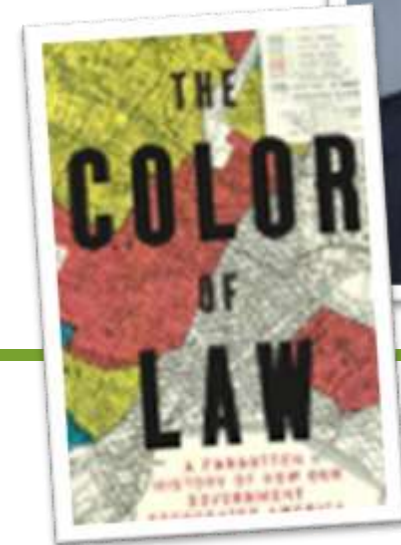

# Today's Moderator



**Moderator**

**Kim Lucas**

Assistant Director of Transportation, City of Pittsburgh



**Warren Logan**

Policy Director of Mobility and Interagency Relations, City of Oakland



**Tony Garcia**

Principal, The Street Plans Collaborative



**Destiny Thomas**

Founder, CEO, Thrivance Group

# Today's Panel



**Moderator**

Kim Lucas

Assistant Director of Transportation, City of Pittsburgh



Warren Logan

Policy Director of Mobility and Interagency Relations, City of Oakland



Tony Garcia

Principal, The Street Plans Collaborative



Destiny Thomas

Founder, CEO, Thrivance Group



# REOPEN PGH



Pittsburgh Department of  
Mobility and Infrastructure

September 11, 2020

# MISSION

---

**Provide the physical mobility necessary to support the social and economic mobility of the people of Pittsburgh through the management, design, improvement, and operation of the public right of way.**

# Department Goals

1. No one dies or is seriously injured traveling on city streets (streets and intersections are intuitive to use, even by an adolescent).
2. Every resident can access fresh fruits and vegetables within 20 minutes travel of home (without requiring a private vehicle).
3. All trips less than 1 mile are easy and enjoyable to achieve by non-vehicle travel.
4. No household must spend more than 45% of income on Housing + Transportation + Energy (for any income quintile).
5. Our streets reflect the values and pride of our city.





# How can we use public space to better support people and businesses?



- Safely
- Quickly
- Cheaply
- Equitably



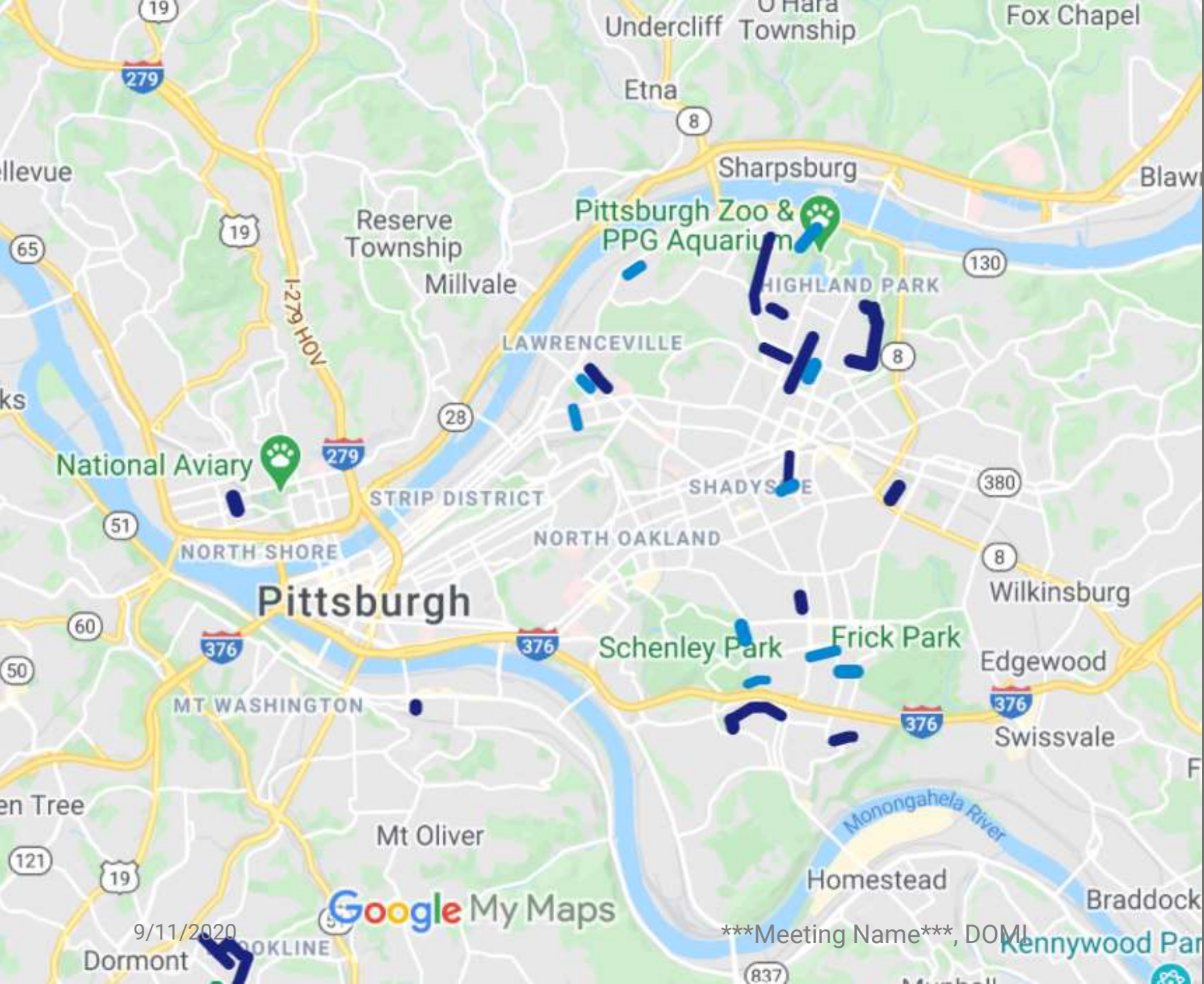

# Slow Streets

- Grant Funding for materials
- Community-led locations
- Community-maintained



# SHORT-TERM LOADING FOR PICK UP & DELIVERY

## 15 MINUTE TIME LIMIT



For information on the City's response to COVID-19, visit [pittsburghpa.gov/mayor/covid-updates](https://pittsburghpa.gov/mayor/covid-updates)

## Pick Up Parking

- Coordinate with nearby businesses for shared use

WILLIAM PEDUTO  
MAYOR



KARINA RICKS  
DIRECTOR

CITY OF PITTSBURGH  
**DEPARTMENT OF MOBILITY & INFRASTRUCTURE**

Department of Mobility and Infrastructure Order No: 20-0001

# GUIDANCE FOR POWERED MICROMOBILITY DEVICE USE IN THE CITY OF PITTSBURGH

## I. Overview and Purpose

### A. Objective

Define and provide direction for the appropriate use and operations for emerging electronic micromobility devices in public rights of way of the City of Pittsburgh to promote safety and support additional low-emission, compact, affordable options for travel.

# Guiding Micromobilit y



# ReOpen Pittsburgh



**Street Modifications for Outdoor Activations**



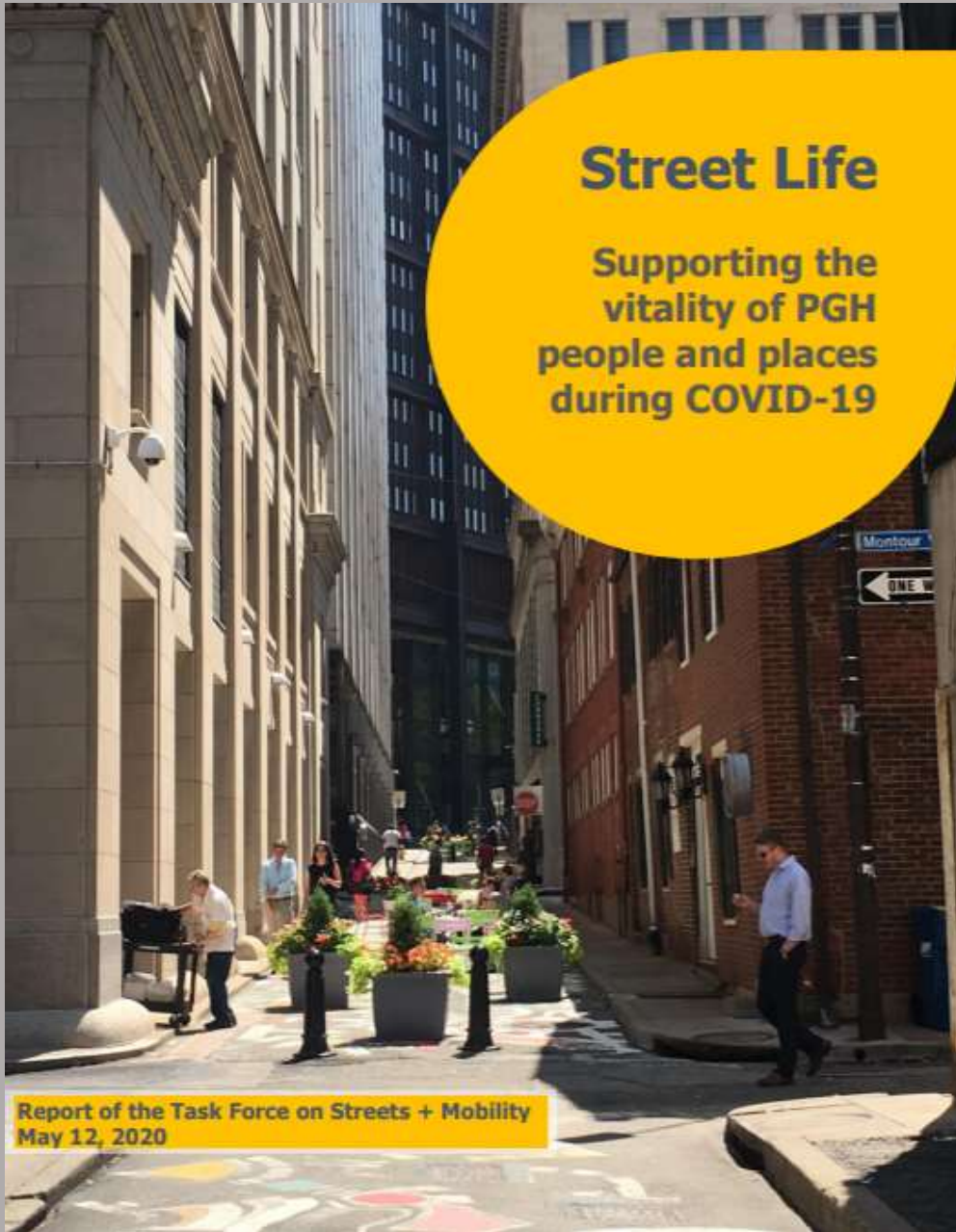

## Street Life

Supporting the  
vitality of PGH  
people and places  
during COVID-19

Report of the Task Force on Streets + Mobility  
May 12, 2020

# Step 1: Task Force Report

The ReOpenPGH Task Force was comprised of City, County, Transit, Community Group, and Business representatives

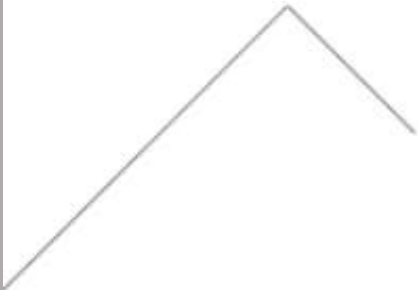

## Sidewalk Café Permit Info

Need more space to operate your business? Explore the options available for using the sidewalk and roadway for queuing space or outdoor seating. Please see our website:

[www.pittsburghpa.gov/domi/covid](http://www.pittsburghpa.gov/domi/covid)

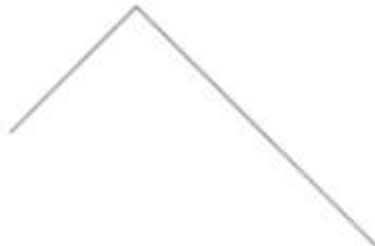

## Step 2: Outreach

- Website
- Elected Representatives
- Weekly Bulletins
- Business Improvement Districts





# Step 3: Coordination

**Dept. Mobility & Infrastructure  
(DOMI)**

Reviews the use of the Right-Of-Way

**Dept. City Planning (DCP) -  
Zoning**

Reviews extension of premises

**Dept. Permits Licenses &  
Inspection (PLI)**

Reviews and permits extension of premises and  
seating

**Dept. of Public Safety**

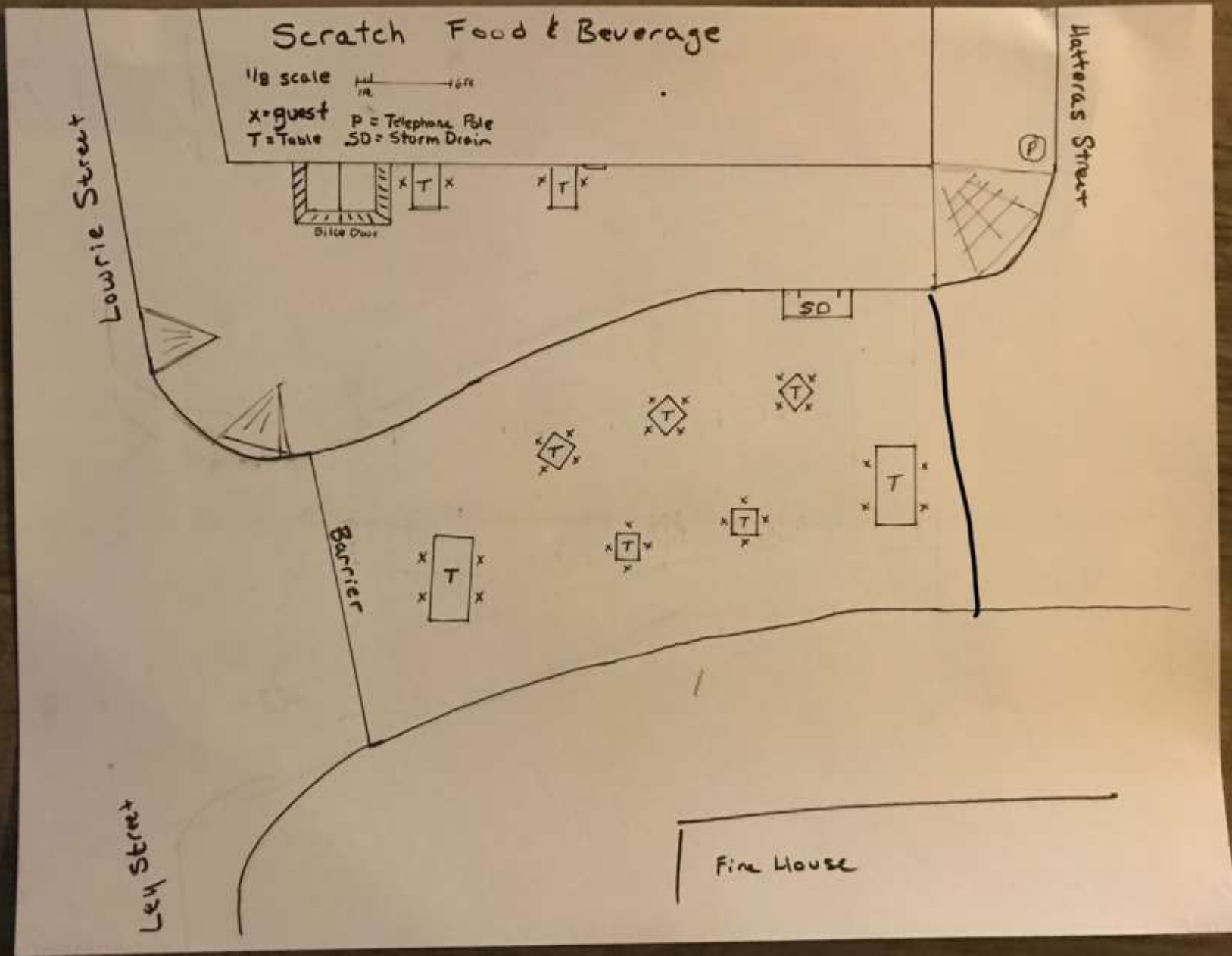

# Step 4: Guidelines & Application:

- Must maintain 6' of pedestrian space
- Must maintain ADA access to all facilities
- Must maintain access to Utilities
- Must maintain access to Fire Hydrants
- Must relocate any impacted ADA Parking Space
- And more:  
[pittsburghpa.gov/domi/covid-19](http://pittsburghpa.gov/domi/covid-19)



## DREAM BBQ DINING SOLUTION OPTION 2 – PLAN VIEW

### Key Opportunities

- Minimal ROW intervention
- Limits potential conflicts with fire station activity
- Retains two-way traffic operation
- Retains parking space for pick-ups

### Key Tradeoffs

- Heavy barricades are required between seating area and travel lane, limiting flexibility once installed
- Inadequate space for 6' distancing between pedestrians and patrons in queuing space along W-side perimeter of Dream BBQ

DRAFT 9/3/20 - Nelson\Nygaard & ACCC



# Step 5: Balance

Q: How do you make sure that your community-led processes aren't leaving anyone behind?

A: Help. Partner-Up. Reallocate resources.





Step 6:  
Enforce  
Inspect.  
Adjust.



# Step 7: The Future

- Evaluate
- Modify
- Winterize
- 2021
- Beyond?





# Sidewalk Café

- Low Impact
- Uses sidewalk against business
- Needs to maintain 6 feet of pedestrian space
- Applicant:  
Independent  
Brewing Company





# Sidewalk Extension

- Extends available sidewalk space
- Good for queuing or waiting space for take out
- Applicant: Apple Shadyside

# Sidewalk Extension

- Combine with Outside Seating
- Large Sidewalk Extension
- Downtown: Penn Avenue
- Applicant: PDP







# Full Street Closure

- Large Full Street Closure
- Wooden Sidewalk Extension
- Oakland: Oakland Avenue
- Applicant: OBID

# Today's Panel



**Moderator**

Kim Lucas

Assistant Director of Transportation, City of Pittsburgh



Warren Logan

Policy Director of Mobility and Interagency Relations, City of Oakland



Tony Garcia

Principal, The Street Plans Collaborative



Destiny Thomas

Founder, CEO, Thrivance Group



# Oakland Streets

ULI Making Moves

Sept. 11, 2020













Keep Safe!  
pedestrian safety



Seminary

RENTAL WASH

CLEAN SCENE







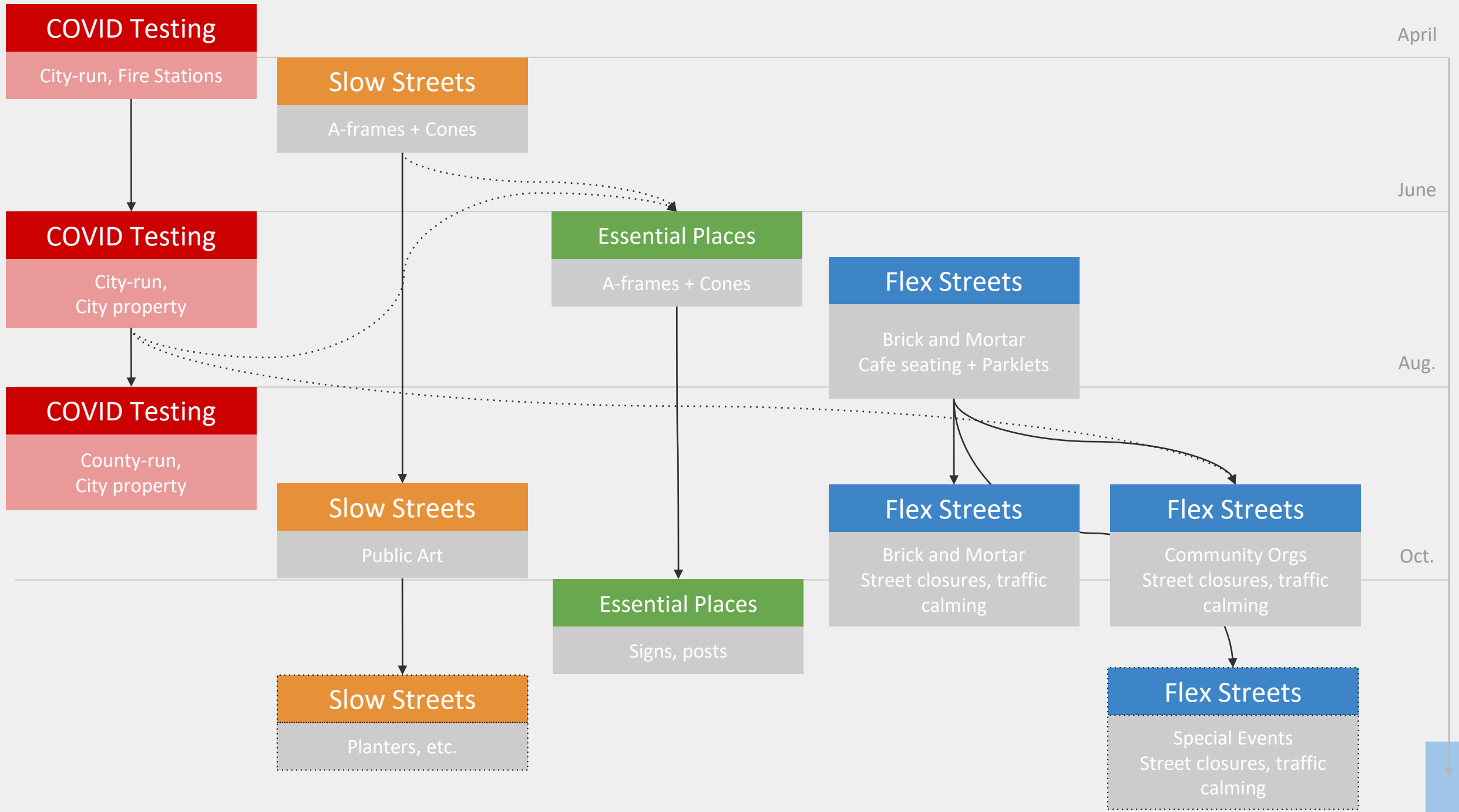



# Lessons Learned

Be .. Responsive

Expeditious

Active

Creative

Collaborative

Helpful

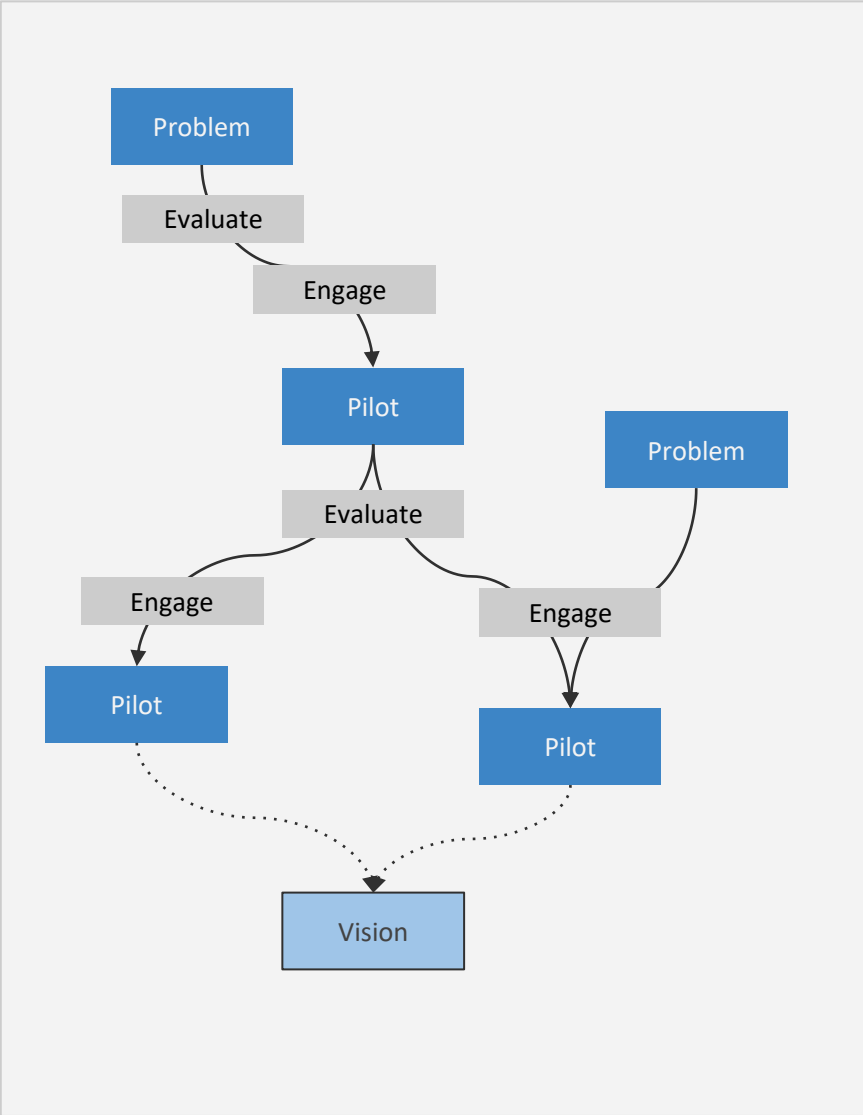
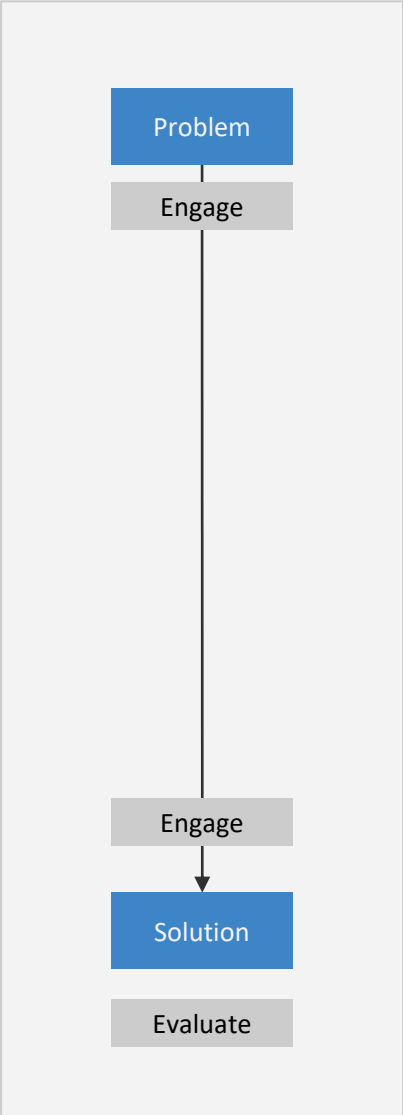

# Oakland Streets

ULI Making Moves

Sept. 11, 2020



# Panel Discussion



**Moderator**

Kim Lucas

Assistant Director of Transportation, City of Pittsburgh



Warren Logan

Policy Director of Mobility and Interagency Relations, City of Oakland



Tony Garcia

Principal, The Street Plans Collaborative



Destiny Thomas

Founder, CEO, Thrivance Group





# LET'S RIDE JC

## Bikeway Design Guide

June 2019



### SAFER PLACES TO WALK

#### CURB EXTENSIONS

Curbside extensions are a key strategy for creating safer walking environments. They provide a buffer between the sidewalk and the street, reducing the width of the travel lane and improving visibility for both pedestrians and drivers.

**DETAILS:**

- Use a minimum 18-inch extension.
- Use a minimum 2-foot clearance from the curb.
- Use a minimum 2-foot clearance from the building.
- Use a minimum 2-foot clearance from the street.
- Use a minimum 2-foot clearance from the sidewalk.
- Use a minimum 2-foot clearance from the curb.
- Use a minimum 2-foot clearance from the building.
- Use a minimum 2-foot clearance from the street.
- Use a minimum 2-foot clearance from the sidewalk.

#### IN CONTEXT

Curbside extensions should be integrated with other street design elements, such as crosswalks, streetlights, and landscaping, to create a cohesive and safe walking environment.

#### APPLICATION GUIDANCE

Curbside extensions are most effective in high-traffic areas, such as downtown districts, transit corridors, and commercial centers. They are also most effective when combined with other safety measures, such as crosswalks, streetlights, and landscaping.

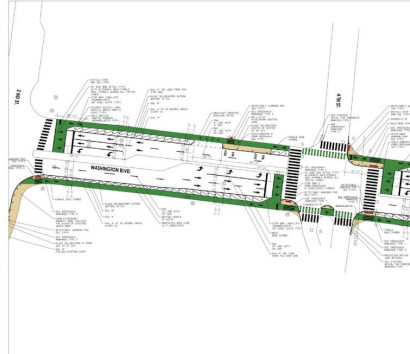











THIS IS  
RIDICULOUS







# Panel Discussion



**Moderator**

Kim Lucas

Assistant Director of Transportation, City of Pittsburgh



Warren Logan

Policy Director of Mobility and Interagency Relations, City of Oakland



Tony Garcia

Principal, The Street Plans Collaborative



Destiny Thomas

Founder, CEO, Thrivance Group

# ABOUT THE THRIVANCE GROUP

## Thrivance Project

Municipal Projects (Transform Fresno)  
Research (Anti-Displacement Calc.)  
Policy (CPR-U)  
Capacity Building (Dignity Institute)  
DICE Projects (Mobility Hub Co-ops)  
Strategy (REAP/GARE)  
Archival Research (Oral History)

## Thrivance Legacy

Dignity Team  
Coalition-Building  
Academic Intervention

## Thrivance Space

Unurbanist Assembly  
Pop-up Demonstrations  
Direct Action

## Thrivance Group Growth Plan

**Year 1: Organizational Capacity | Year 2: External Capacity | Year 3: Innovation and Implementation**





**SOCIAL CLIMATE ANALYSIS**

# SCA PROCESS

**Part 1 - Preliminary Assessment of Displacement Factors**

**Part 2 - Research Design and Strategy Development**

**Part 3 - Findings, Final Recommendations, and Implementation Strategies**



# COMMON SCA PARTNERS

Employment Access Advocates and Economic Development Groups  
Implementers and Advocacy Groups with Deep Institutional History of  
Infrastructure Investment Patterns  
Housing Authority Staff and Housing Justice Advocates  
Racial Justice Advocates  
Public Health Professionals  
Anti-racism Campaigns

# OPPORTUNITIES FOR DEEPER UNDERSTANDING

Labor Profile

Current Phase of Displacement

Zoning Laws/History

Mobility Attitudes/Perceptions

Sites for Cultural Thrivance

Youth Engagement

Ongoing Harm



A large crowd of people at a protest, many wearing face masks. Several signs are visible, including one that reads "Justice is Denied Justice" and another that says "Breonna George ando". The overall scene is a dense gathering of individuals.

# ACTIVATED ANTI-DISPLACEMENT STRATEGY



# ACTIVATED ANTI-DISPLACEMENT RUBRIC

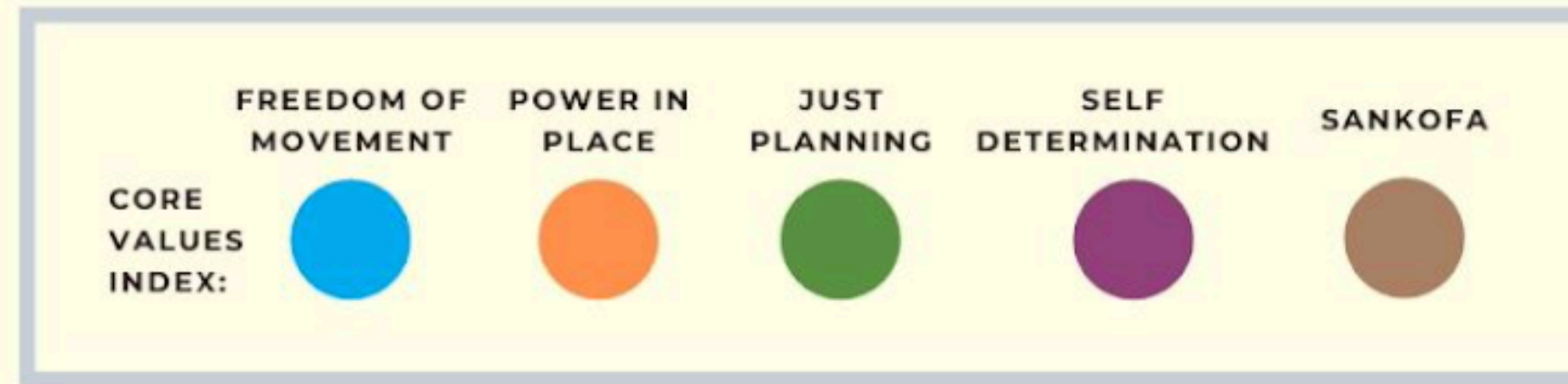

	PHASE OF DISPLACEMENT				STRATEGY COMPONENT		
	1	2	3	4	POLICY	ADVOCACY	PLANNING
Connecting Community							
Capacity Building							
Organizing							
Dialogue							
Direct Service							
Participatory Research							
Participatory Planning							





**ORAL HISTORY ARCHIVING**

# **COMMON ORAL HISTORY THEMES**

**Displacement**

**Culture - Music & Visual Art**

**Visibility/Erasure**

**Age/Eras/Generational Migration**

**Centering race (calling out multiple levels of erasure)**





**POLICY GAP ANALYSIS**

# **POLICY GAP PRELIMINARY FINDINGS**

**Need for immediate development interventions**

**Restorative zoning**

**Right to return (season)**

**Equity commitments from/with all developers**





**INFO HUB DEPLOYMENT**

# **INFO HUB DEPLOYMENT PLAN**

**Essential Businesses**

**Safety Net Service Providers**

**Digital Access**

**Fluid and Flexible Deployment Structure**





# DIGNITY LABS

# **DIGNITY LAB WORKSHOPS**

- 1. Introduce approach and invite residents to co-lead**
- 2. Provide update through resident-led workshop**
- 3. Final policy recommendations community workshop**



# Panel Discussion



**Moderator**

**Kim Lucas**

Assistant Director of Transportation, City of Pittsburgh



**Warren Logan**

Policy Director of Mobility and Interagency Relations, City of Oakland



**Tony Garcia**

Principal, The Street Plans Collaborative



**Destiny Thomas**

Founder, CEO, Thrivance Group



# Confronting COVID-19

## Making Moves: Transportation, Public Space, and Equity in the Time of Coronavirus

Join us in October for ULI's Virtual Fall Meeting  
[fall.uli.org](https://fall.uli.org)

Check your email for a link to today's webinar recording  
and a post-session survey

[health@uli.org](mailto:health@uli.org)